



# 1510FK-105 ORAS SWEA ECO WASHBASIN FAUCET

SINGLE-LEVER, COLD START

EAN: 6414150105913 [static.oras.com/1510FK-105](http://static.oras.com/1510FK-105)



Introducing the Oras Swea Washbasin Faucet, a stylish and functional addition to modern bathroom. With a chrome surface treatment, single-lever design, and Cold Start feature, this faucet is energy efficient and easy to use. The 3S-installation system guarantees safe and simple mounting. Plus, its competitive pricing and ecological design make it a perfect solution for various styles and needs.

- ECO Building
- Deck mounted
- Chrome
- Fixed spout
- Standard aerator
- Single operating lever/handle, Hot/Cold symbols
- Chain holder without chain
- Limitation option for maximum temperature and flow-rate, Energy saving variation (Cold Start) - cold water in the middle position
- ø 35 mm ceramic cartridge for flow and temperature control
- Flexible inlet pipes
- 3S-installation system for safe and simple mounting

## TECHNICAL DATA

### TECHNICAL PROPERTIES

|                  |               |
|------------------|---------------|
| Hot water supply | max. +70°C    |
| Working pressure | 50 - 1000 kPa |
| Connection size  | G3/8          |
| Material         | Brass         |

### REGULATIONS

|             |        |
|-------------|--------|
| EN standard | EN 817 |
|-------------|--------|

### APPROVALS AND DECLARATIONS

|                           |           |
|---------------------------|-----------|
| SE Energy Mark            | 1536      |
| KIWA SE                   | 1441      |
| Declaration of conformity | DoC       |
| EPD                       | S-P-06391 |

### SUSTAINABILITY

|                               |       |
|-------------------------------|-------|
| EPD module A1-A3 (kg CO2 eq.) | 5,28  |
| EPD module A4 (kg CO2 eq.)    | 0,15  |
| EPD module C2 (kg CO2 eq.)    | 0,01  |
| EPD module C3 (kg CO2 eq.)    | 0,01  |
| EPD module C4 (kg CO2 eq.)    | 0,04  |
| EPD module D (kg CO2 eq.)     | -3,76 |

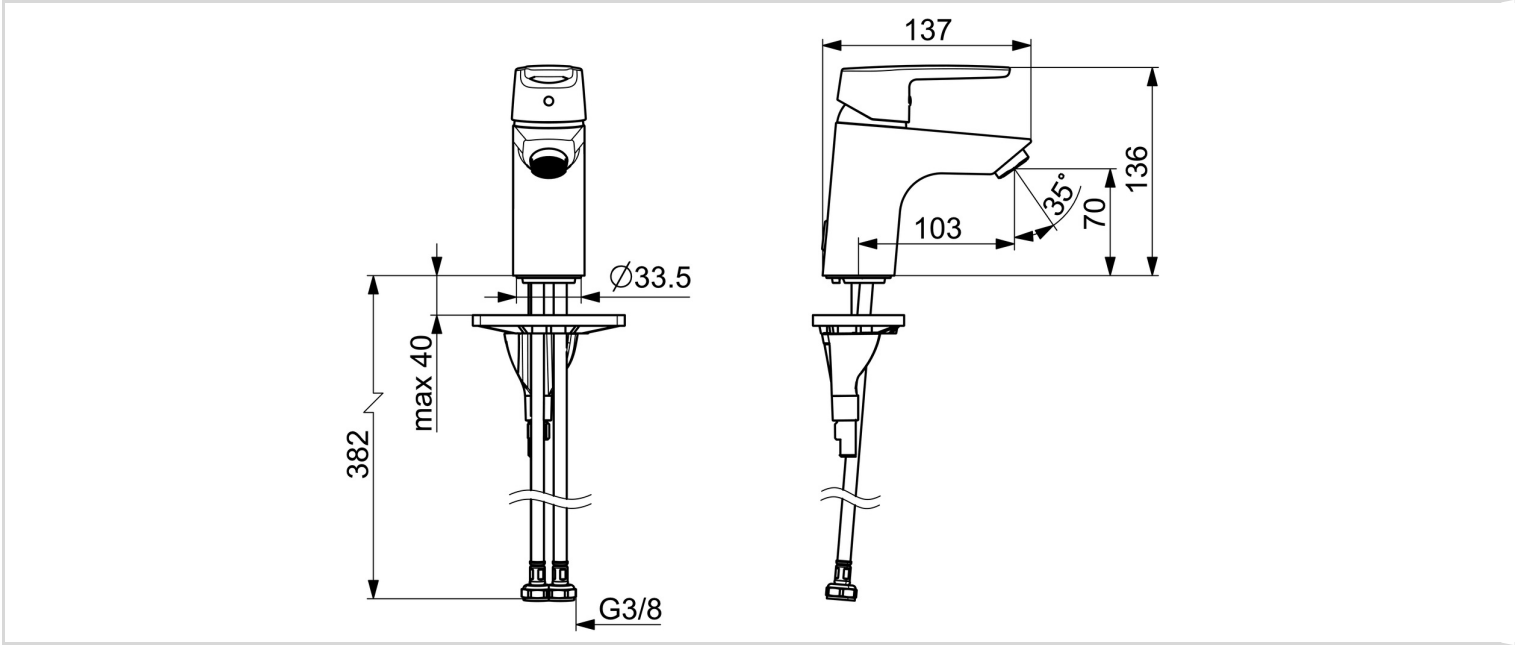

**SPARE PARTS**

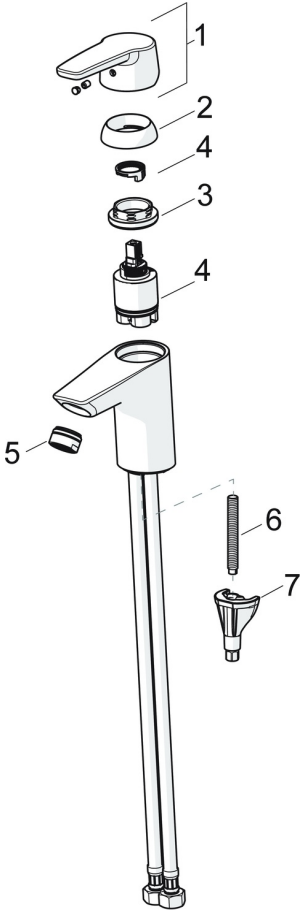

**SP1510FK**

| Name  | Code     |
|---|----------|
| 01 Lever Chrome                             | 1003170V |
| 02 Covering cap Chrome                      | 601967V  |
| 03 Tightening nut, M40x1, SW30              | 1003409V |
| 04 Cartridge, 3.5 cold start                | 602672V  |
| 05 Aerator, M24x1, 6 l/min Chrome           | 601974V  |
| 05 Aerator, M24x1 PCA 5 l/min (-105) Chrome | 1003828V |
| 06 Fixing screw, M8x1, L=140                | 601970V  |
| 07 Fixing set                               | 602610V  |